



GREENWAY

SUSTAINABLE
DESIGN
INNOVATION

Landscape Architects



PLANT SCHEDULE

No	TREES	Size at Planting
Ac	5 Acer capadocicum	10-14cm girth, bare root
Ag	1 Acer ginnala	12-14cm girth DG, multistem, min 5 breaks
NEQ	2 Acer platanoides Emerald Queen	14-16cm girth, bare root
NEQ	3 Acer platanoides Emerald Queen	16-18cm girth, multistem (feathered)
R	1 Betula jacqumoni	3.5m, multistem, multibark
Pa	2 Falcatia x acedra	16-18cm girth, multibark
Pa	2 Falcatia x acedra	36L, 2.5-3.5m
Q	1 Quercus robur	50L, 12-14cm girth

No	SHRUBS AND HEDGING PLANTS	Size at Planting	Spacings
10	Chorisia temata	10L, 600-750	As shown
3	Cornus mas	RB, 1000-1200	As shown
5	Deutzia Rosea	10L, 500-600	As shown
1	Fraxinus excelsior 'G4 Edge'	10L, 800-1000	As shown
428	Fagus sylvatica	OG, 450-600	31m
1	Forsythia x intermedia Spectabilis	RB, 800-1000	As shown
12	Lonicera fragrantissima	10L, 800-1000	As shown
12	Philadelphus Froctator	10L, 800-1000	As shown
2	Photinia Fraser Red Robin	10L, 800-1000	As shown
8	Prunus laurocerasus	10L, 800-1000	As shown
8	Syringa macrobotrya	10L, 800-1000	As shown
2	Syringa vulgaris	RB, 1000-1800	As shown
13	Viburnum tinus 'Brilliant'	RB, 800-1000	As shown
17	Philadelphus Virginian	10L, 800-1000	As shown
15	Viburnum burkwoodii	10L, 800-1000	As shown
15	Viburnum tinus	10L, 800-1000	As shown
1	Viburnum tinus French White	10L, 800-1000	As shown
1	Viburnum prunifolium	10L, 800-1000	As shown

No	SHRUBS AND HEDGING PLANTS	Size at Planting	Spacings
103	Berberis media 'Pricklypear'	3L, 400-600	4
36	Chorisia temata	3L, 450-600	3
27	Chorisia temata 'Noble Pear'	3L, 450-600	4
25	Cornus alba 'Nurea'	OG, 450-600	2.5
19	Cornus alba 'Spirital'	OG, 450-600	2.5
8	Cornus sanguinea 'Midwinter Fire'	OG, 450-600	4
8	Salix purpurea 'Rothemann'	2L, 700-900	1.5
33	Eucalyptus fulgens 'Emerald Queen'	3L, 450-600	4
52	Forphyta 'Blackbird Farm'	2L, 500-700	4
14	Lonicera nitida 'Baggesvik Gold'	2L, 450-600	4
623	Lonicera nitida	2L, 300-450	3
17	Machonia aquilum	2L, 450-600	3
3	Phoradendron 'Purpureum'	10L, 800-1000 (1)	4
3	Phoradendron 'Dance'	3L, 450-600	2.5
14	Potentilla fruticosa 'Koboldbeza'	3L, 300-450	3.5
7	Potentilla fruticosa 'Eldorado'	3L, 300-450	3
103	Pyracantha 'Red Curtains'	2L, 300-400	5
38	Rosa rugosa 'Rubra'	OG, 450-600	3
26	Silvestria japonica 'Rubra'	3L, 300-450	4
25	Spiraea 'Regina'	3L, 300-450	3
5	Thalictrum 'Virginian'	3L, 300-450	As shown
17	Viburnum tinus 'French White'	3L, 450-600	2.5
12	Viburnum tinus 'Erdbeer'	3L, 450-600	3
250	Vitis 'Rieser'	3L, 200-300	4
9	Vitis 'Rieser'	2L, 100-150	3
12	Wegelia 'Hardie Victoria'	3L, 300-450	4

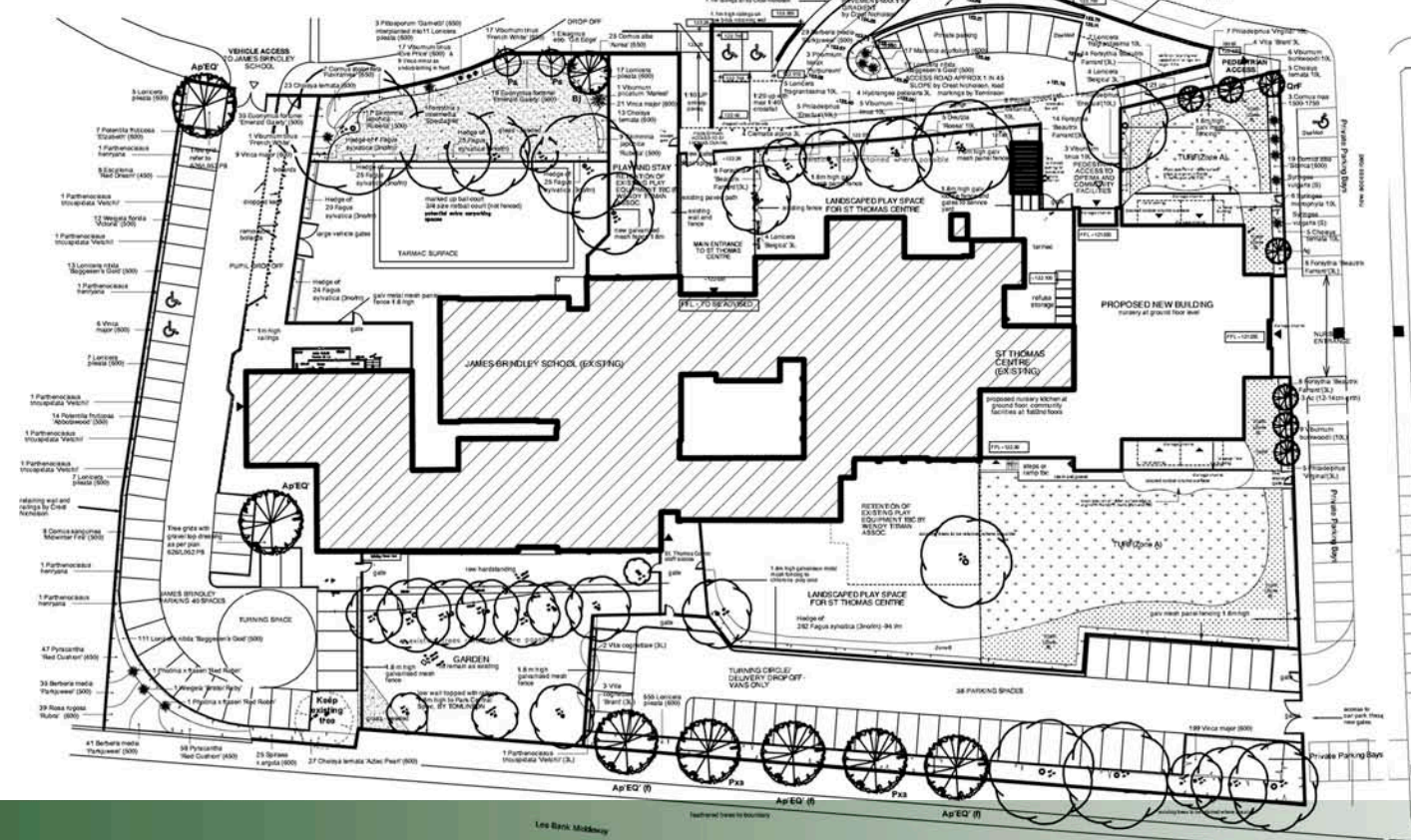

LEGEND

- Proposed Heavy Standard Tree
- Multistem tree (16-18cm girth)
- Proposed Specimen Corner planting
- Specimen shrubs
- Specimen climbers
- Amenity shrub and groundcover planting
- Grass area - seeded (Specification - shade tolerant mix)
- Grass area - turfed (Zone A - see notes)
- Grass area - turfed (Zone B - see notes)

Notes:

Zone A - 150mm depth clean, weed free topsoil to BS1982:1994 Premium Grade on decompact, free draining vegetable subsoil, free of builders rubble, foreign matter >75mm.

Zone B - Tree and Shrub Areas
450mm depth clean, weed free topsoil to BS1982:1994 Premium Grade on decompact, free draining vegetable subsoil, free of builders rubble, foreign matter >75mm. Areas not turfed to receive 75mm mulch for planting by others after completion. Maximize organic make up.

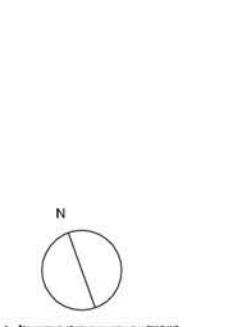

FOR PLANNING

GREENWAY LANDSCAPE ARCHITECTS

THE STUDIO, GREENWAY ARCHITECTURAL, 111 LEA BANK MIDDLEWAY, BIRMINGHAM, B15 1JG

ST THOMAS CENTRE

Planting Design

BIRMINGHAM CITY COUNCIL

GLA 256 001

ST THOMAS'S CENTRE, LEE BANK MIDDLEWAY - PLANTING PLAN